

UNIVERSAL MOBILE PACKING LINE - UMBL

PURPOSE:

UMBL is intended for disassembly of particular military and civil materials from ISO containers and from pallets, and for assembly of supplying sets on nonreturnable pallets with standard dimensions, suitable for air transport.

There is supposed primarily the assembly of foodstuff, packed water, and other non detailed specified common materials.

More material categories can be stored on one pallet. The assembled material is fastened on the pallet by straps and is protected against climatic conditions by foil.

The assembled material will be transported from UMBL to the destination (forwarded issuing location, directly to supplying battalions and companies, etc.) by user's transporting means.

UMBL is configured for use either on the Czech Republic territory or on LOGBASE deployed stage, in line with operating conditions according to the Chapter 4.4. The material, assembled by packing line, will be intended for supplying of abroad operating Czech troops, eventually of brigade special tasks groups or European Battle Group (EUBG).

COMPOSITION:

- 1 – main manipulating and assembly working place (UMBL/hall);
- 2 – administrator's working place (UMBL/A);
- 3 – packing and marking working place (UMBL/B);
- - hardware and APV software (UMBL)

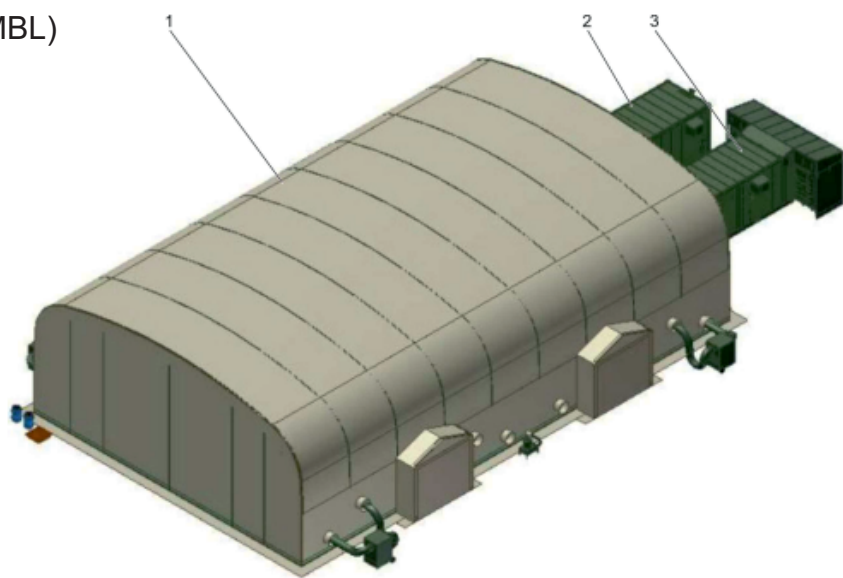

UNIVERSAL MOBILE PACKING LINE - UMBL

BASIC TACTICAL AND TECHNICAL DATA:

UMBL Voltage System		
– low voltage	three-phase 3×230/400 V, 50 Hz, 5 p	
– electrical energy source	distribution network or generating set 60 kW	
UMBL Energy Balance		
Fuel transported reserve (NM-54) for 24-hour operation		2 × 350 dm ³
		Rated Power
All appliances total (in case of parallel operation):	Winter [kW]	Summer [kW]
UMBL/hall	10,1	37,1
UMLB/A	7,6	3,9
UMBL/B	19,4	17,7
SET TOTAL	37,1	58,7

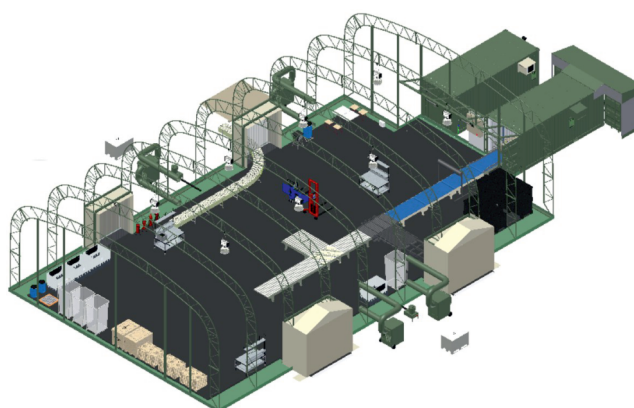
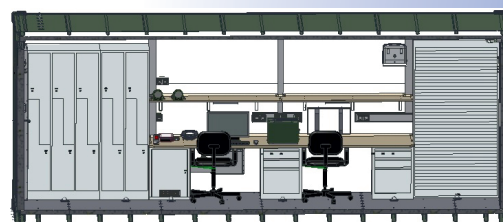

Light assembled hall, EURO UT Type	
Outdoor dimensions:	
– width	15 000 mm
– lenght	24 000 mm
– total height	6 800 mm
UMBL/A	
External dimensions:	
– width	6 058 mm
– lenght	2 438 mm
– height	2 438 mm
Internal dimensions:	
– length max.	5 800 mm
– width max.	2 245 mm
– height	2 090 mm
Weight	4 050 kg
Maximal total weight	12 000 kg
Stacking ability	1+3 (for the purpose of military use) 1+8 (for the purpose of navy transport)

UMBL/B	
External dimensions:	
– width	6 058 mm
– lenght	2 438 mm
– height	2 438 mm
Internal dimensions:	
– length max.	5 800 mm
– width max.	2 245 mm
– height	2 090 mm
Weight	6 100 kg
Maximal total weight	12 000 kg
Stacking ability	1+3 (for the purpose of military use) 1+8 (for the purpose of navy transport)

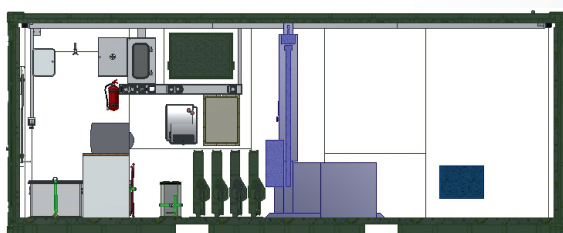
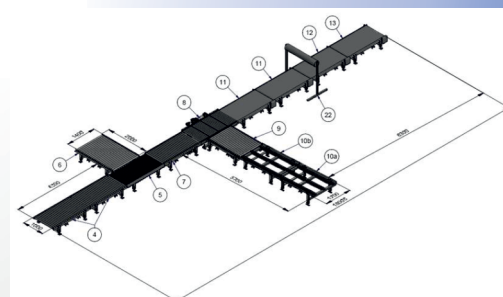

Packing line (AUTOMAT mode)	
– capacity max.	20 pallets/hour
– height of pallet with material	max. 1 500 mm
– distance of material on the pallet from side stop of strapping machine	min. 600 mm max. 250 mm
– weight of pallet with material	max. 1 000 kg (centre of gravity in the middle of pallet!) min. 80 kg